

Carrying consoles, swivelling to the left and right
for easy and efficient die change on the press bed
load per pair of 10 to 60 kN

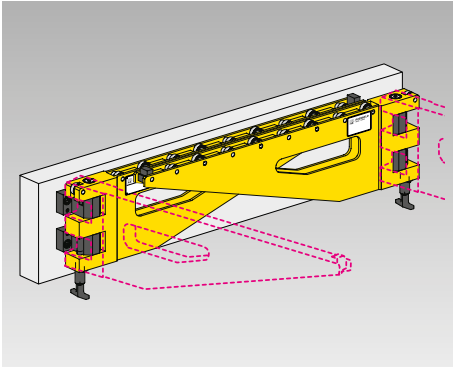

Advantages

- Safe handling of heavy dies with ease
- Less downtime by easy and efficient die change
- High-quality, shock-resistant coating
- High load
- Low space requirement due to swivelling carrying consoles

Application

Carrying consoles allow a safe, effort and time-saving change or transport of heavy dies.

Description

The carrying consoles are hung in the hooks on the die changing side of the press. The hooks are supplied with the consoles. The consoles are used as a pair. Their size must be selected to suit the highest die weight.

The die is loaded onto the consoles using a crane or a forklift truck. The carrying rollers consist of high-strength hardened needle bearings. The end stop can be bypassed in one direction.

The surface is provided with a shock-resistant coating in RAL1004, golden yellow.

Swivelling carrying consoles are supplied in pairs with pre-mounted holders, ready for connection.

Special designs and double-swivel carrying consoles are available on request.

Delivery

2 carrying consoles (left and right side)
4 holders (pre-mounted)

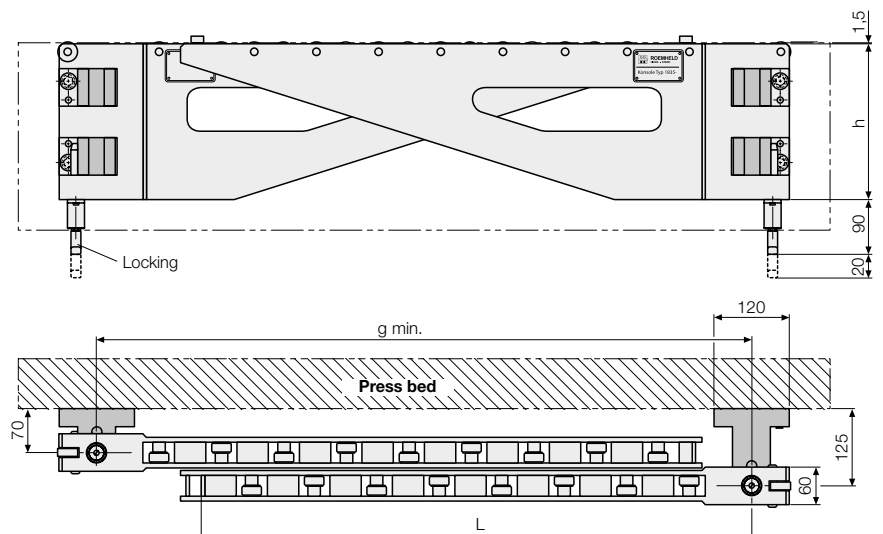

The carrying consoles can be swivelled to the left and right

Hole pattern for holders

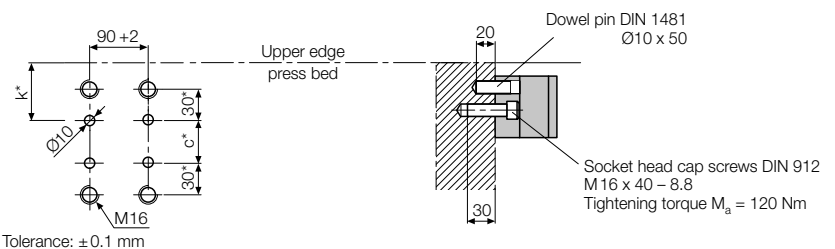

Application example



Swivelling carrying consoles on a press

Technical data

Load (pair) [kN]	Support length L [mm]	Dimensions [mm]				Weight (pair) [kg]	Part no. (pair)
		c ±0.1	g	h	k ±0.1		
10	500	20	550	200	91.5	46	818351001
10	1000	70	1050	250	91.5	74	818351002
20	1000	120	1050	300	91.5	85	818351003
20	1250	170	1300	350	91.5	108	818351004
40	1000	210	1050	450	121.5	130	818351105
40	1250	260	1300	500	121.5	160	818351106
60	1000	310	1050	550	121.5	165	818351107
60	1250	460	1300	700	121.5	230	818351108



Carrying consoles, hanging

for easy and efficient die change on the press bed
 load per pair 5 to 30 kN

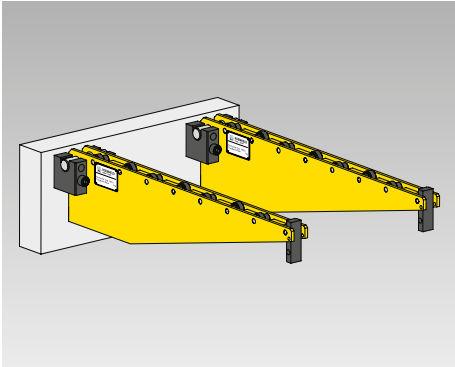

Advantages

- Safe handling of heavy dies with ease
- Less downtime by easy and efficient die change
- High-quality, shock-resistant coating
- High load

Application

Carrying consoles allow a safe, effort and time-saving change of heavy dies on the press bed.

Description

The carrying consoles are hung in the hooks on the die changing side of the press. The hooks are supplied with the consoles. The consoles are used as a pair. Their size must be selected to suit the highest die weight.

The die is loaded onto the consoles using a crane or a forklift truck. The carrying rollers consist of high-strength hardened needle bearings. The end stop can be bypassed in one direction.

The surface is provided with a shock-resistant coating in RAL1004, golden yellow.

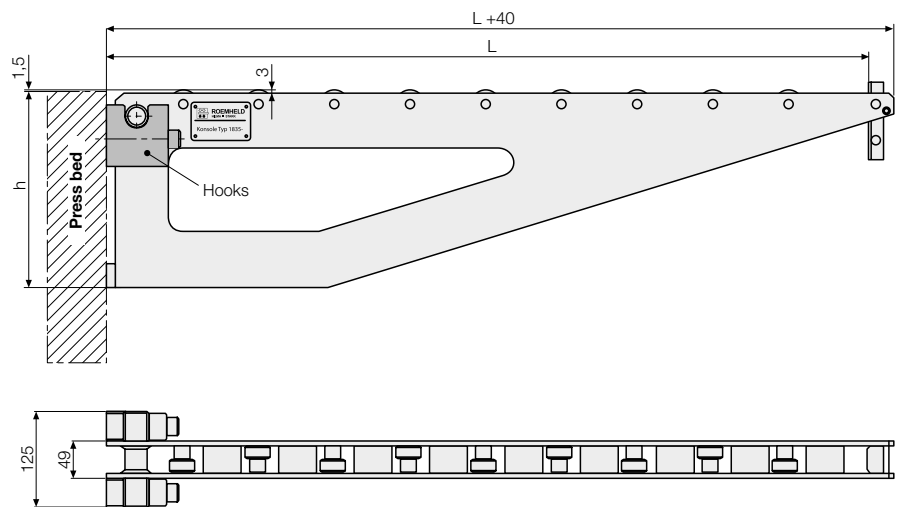

Delivery

2 carrying consoles (pair)
 1 set of hooks (4 off)

Accessories

Hooks

Hanging consoles may be used for several presses. In this case, an additional set of hooks is required and can be ordered as an accessory or replacement (1 set = 4 off).

Part no. 7 1835 0007

Hole pattern for hooks

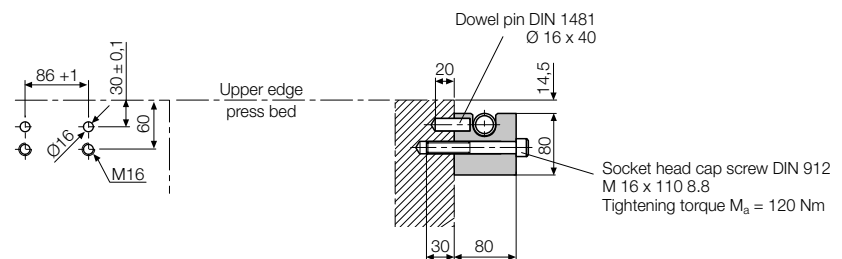

Technical data

Load (pair) [kN]	Support length L [mm]	Height h [mm]	Weight (pair) [kg]	Part no. (pair)
5	500	120	23	8 1835 0001
10	500	150	26	8 1835 0002
10	800	180	40	8 1835 0003
10	1000	250	48	8 1835 0104
20	800	250	40	8 1835 0105
20	1000	300	57	8 1835 0006
20	1250	350	80	8 1835 0107
30	800	400	60	8 1835 0008
30	1000	450	74	8 1835 0009
30	1250	500	107	8 1835 0010

Customised carrying consoles

as e.g. sliding carrying consoles are available on request.



Hanging, sliding carrying consoles



Carrying consoles, supported

for easy and efficient die change on the press bed
 load per pair 20 to 250 kN

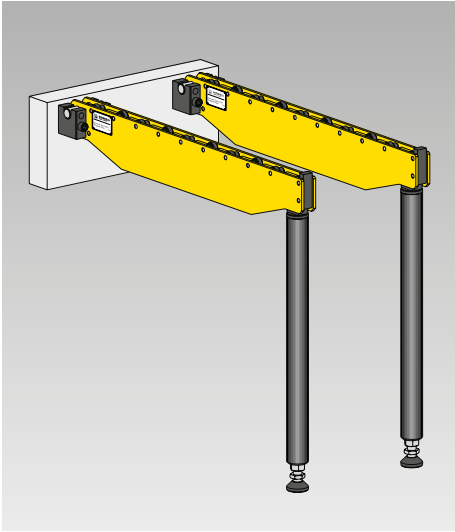

Advantages

- Safe handling of heavy dies with ease
- Less downtime by easy and efficient die change
- High-quality, shock-resistant coating
- High load

Application

Carrying consoles allow a safe, effort and time-saving change of heavy dies on the press bed.

Delivery

2 carrying consoles (pair)
 1 set of hooks (4 off)
 2 supporting feet

Description

The carrying consoles are hung in the hooks on the die changing side of the press. The hooks are supplied with the consoles. The consoles are used as a pair. Their size must be selected to suit the highest die weight. In order to cope with heavy and large dies, the console is provided with an additional support.

To compensate the unevenness on the floor, the supports are designed as adjustable supports with a ball-and-socket joint. The support height may be changed subsequently by ± 60 mm.

The die is loaded onto the consoles using a crane or a forklift truck. The carrying rollers consist of high-strength hardened needle bearings. The end stop can be bypassed in one direction.

The surface is provided with a shock-resistant coating in RAL1004, golden yellow.

Accessories

Hooks

Hanging consoles may be used for several presses. In this case, an additional set of hooks is required and can be ordered as an accessory or replacement. (1 set = 4 off)

Load [kN]	Part no.
20 – 40	718350007
60 – 100	718350021
160 – 250	718350022

Application example



Technical data Dimensions

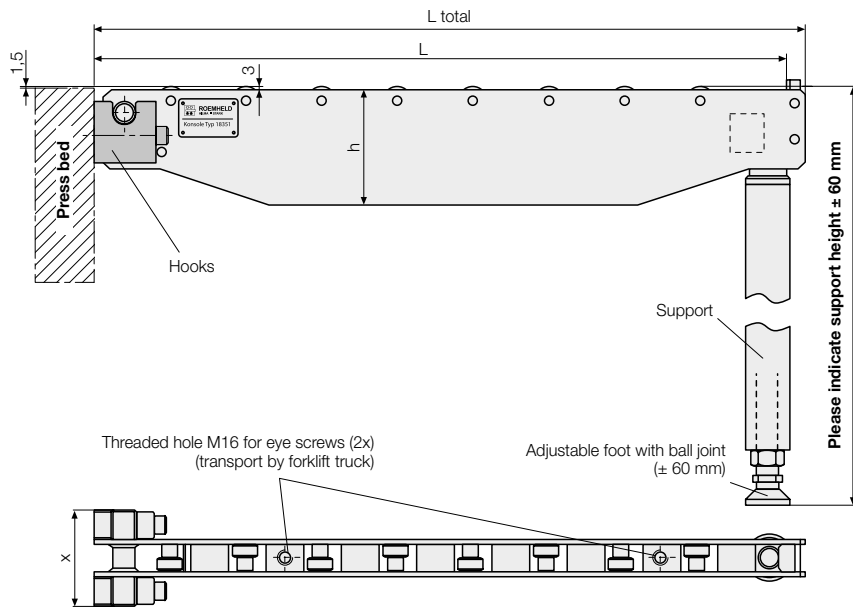

Hole pattern for hooks

Console 20 – 40 kN Console 60 – 100 kN

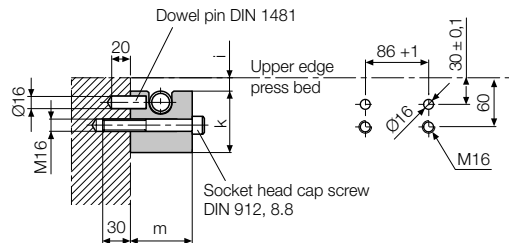

Socket head cap screws DIN 912 M16 x 100
Tightening torque Ma = 120 Nm
Dowel pin DIN 1481 Ø16 x 40

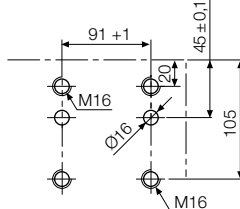

Socket head cap screws DIN 912 M16 x 50 and M16 x 110
Tightening torque Ma = 120 Nm
Dowel pin DIN 1481 Ø16 x 50

Console 160 – 250 kN

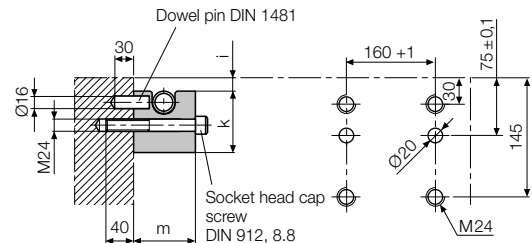

Socket head cap screws DIN 912 M24 x 70 and M24 x 160
Tightening torque Ma = 250 Nm
Dowel pin DIN 1481 Ø20 x 80

Technical data

Load (pair) [kN]	Support length L [mm]	L total [mm]	h	Dimensions [mm]				Weight [kg]	Part no. (pair)
20	1000	1040	150	14.5	80	80	125	82	818353001
20	1250	1290	180	14.5	80	80	125	100	818353102
20	1600	1640	200	14.5	80	80	125	116	818353003
40	1000	1040	200	14.5	80	80	125	80	818353204
40	1250	1290	200	14.5	80	80	125	90	818353205
40	1600	1640	225	14.5	80	80	125	110	818353206
60	1000	1030	200	5	115	100	131	85	818353209
60	1250	1280	220	5	115	100	131	100	818353210
60	1600	1630	240	5	115	100	131	125	818353211
60	2000	2030	270	5	115	100	131	150	818353212
100	1250	1280	250	5	115	100	131	115	818353213
100	1600	1630	280	5	115	100	131	140	818353214
100	2000	2030	320	5	115	100	131	175	818353215
160	1600	1685	260	5	170	150	216	390	818353216
160	2000	2085	260	5	170	150	216	475	818353217
160	2500	2585	280	5	170	150	216	605	818353218
250	2500	2585	360	5	170	150	216	615	818353220

Delivery

2 carrying consoles (pair)
1 set of hooks (4 off)
2 supporting feet

Please specify the exact support height when ordering.

Example of ordering:

818353001, support height 1000 mm

Console 1000 mm long
max. 20 kN

Support height 1000 mm



Die changing consoles, electrically driven for easy and efficient die change on the press bed with push-pull drive, die weight of up to 25 tons



Advantages

- Safe handling of heavy dies with ease
- Less downtime by easy and efficient die change
- Small batch sizes can be easily realized
- High load
- Easy handling
- Easy insertion of the dies, either manually or automatically, with roller or ball bars
- Individual system with integration of the press possible
- Flexible use at several presses

Application

Die changing system directly adapted to the press for effort and time-saving change of heavy dies.

The drive system has been developed on the basis of standard die changing consoles and can be easily installed as it requires only little space. Thus, it is very suitable for both retrofitting and new constructions.

Description

The die changing system with special push-pull drive makes handling of dies easier and ensures effort and time-saving change of dies with a maximum weight of 25 tons in places difficult to access.

(Higher loads on request)

Roller and ball bars in the T-slots of the bed provide for easy insertion of the die. Individual solutions including automatic die changing and integration in the press are possible.

Dimensioning and further technical details in the course of the project. Please contact us!

Function

The drive unit and the carrying console are hung in hooks provided on the press for this purpose and then locked. The die is deposited on the consoles using a crane or a forklift truck. After the die has been deposited, it can be connected to the push-pull docking device of the changing station.

The integral chain drive system allows the user automatic die loading and positioning, just by depressing a push-button on a separate remote control pendant.

During a die change, the press bed is free, i.e. the push and pull elements do not project over the press bed. Also the rear side of the press is completely free. This changing station is suitable for almost any press, can be easily removed and is easy to handle.

Application examples



Die changing console with drive



Die changing console with drive



Die changing console with drive and side loading of the press.

Variants of the die changing console

Various variants with two driven, synchronized drive consoles and with drive motor at left/right side. The length of the console, adaptor and loads are flexibly selectable.

